

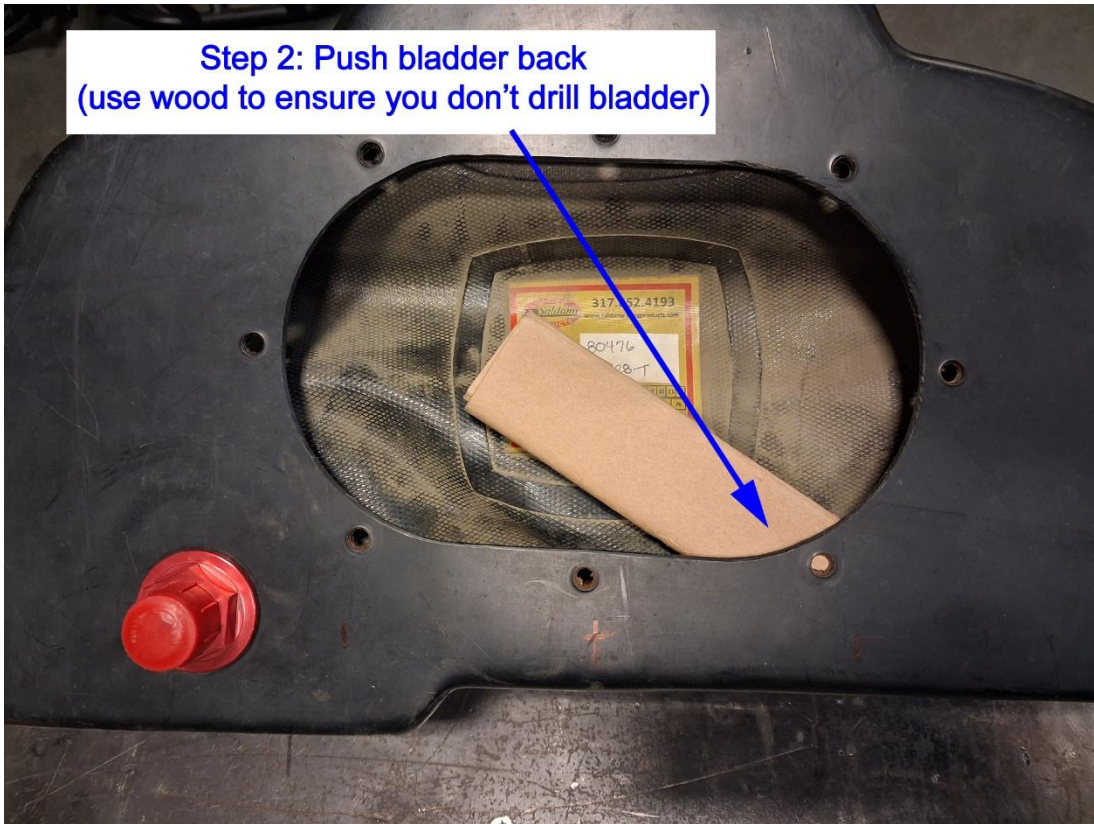

Step 2: Push bladder back
(use wood to ensure you don't drill bladder)

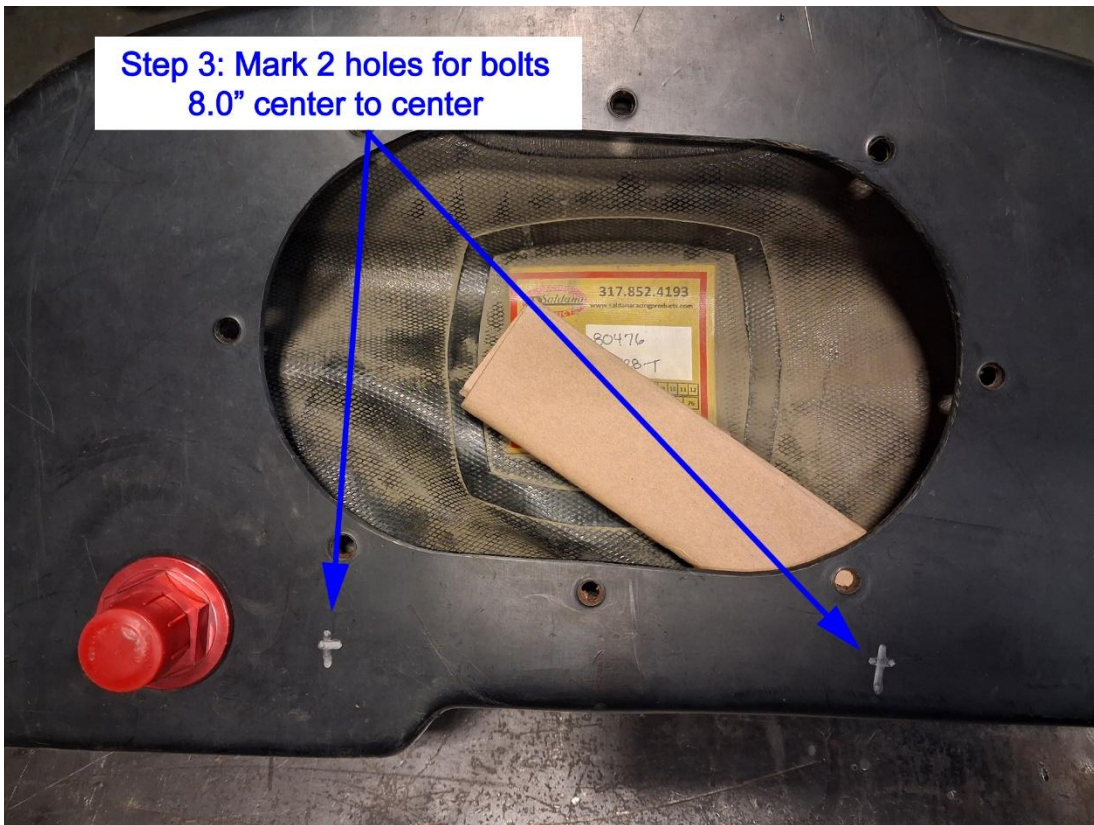

Step 3: Mark 2 holes for bolts
8.0" center to center



Step 4: Drill the two holes.
Hole = 5/16"



Step 5: Insert "dogbone" bracket
into the two holes

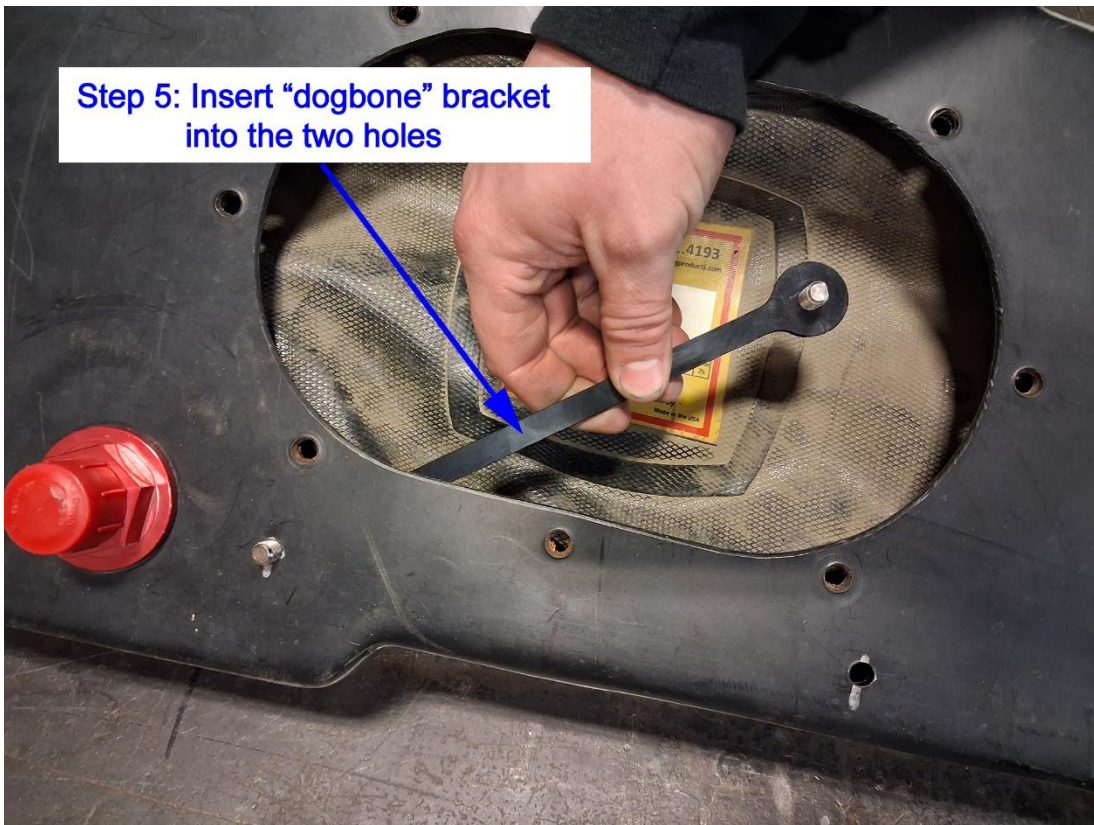



Step 7: Install bladder stuffing plate

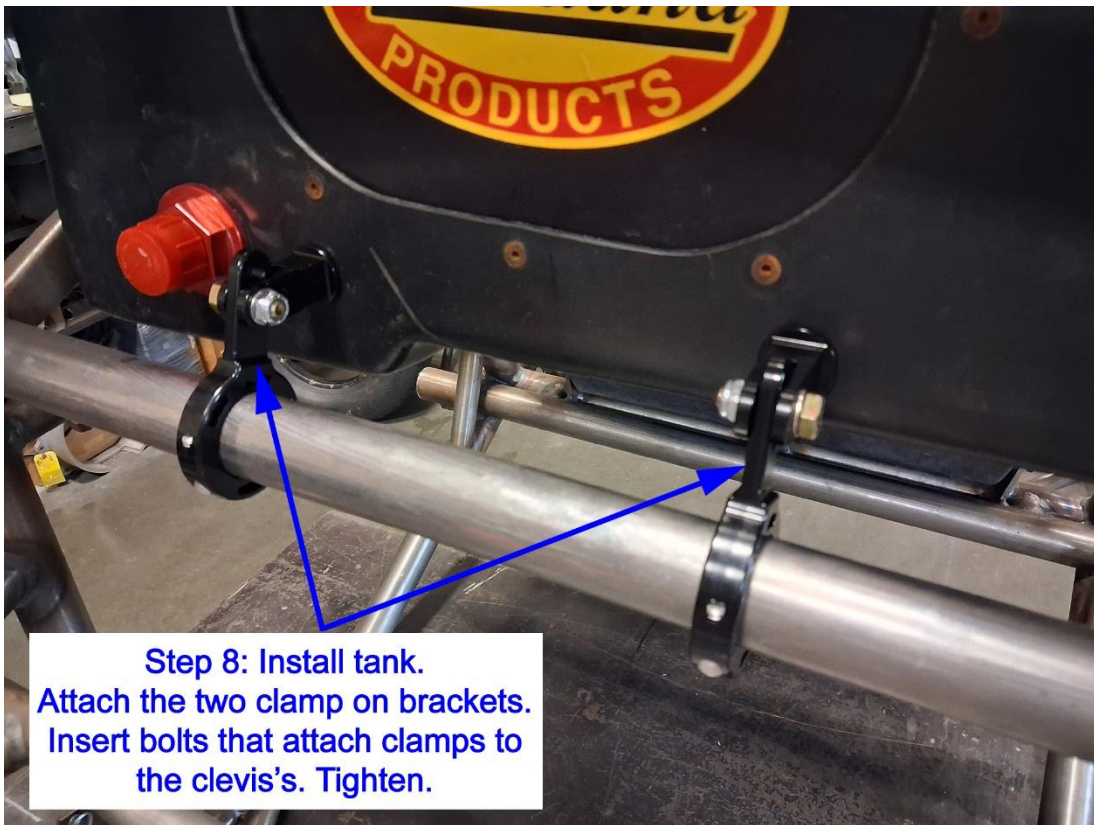

Step 8: Install tank.
Attach the two clamp on brackets.
Insert bolts that attach clamps to
the clevis's. Tighten.